

Ideal Hot & Cold Tap

Available Spring 2019

IHT D PSS		IHT D MSS		IHT D GSS		IHT D BSS		IHT D YSS		IHT D RSS	
											
Polished Stainless Steel		Matte Stainless Steel		PVD Gun Metal Gray™ Stainless Steel		PVD Satin Black Stainless Steel		PVD Brushed Gold Stainless Steel Limited Edition		PVD Rose Gold Stainless Steel Limited Edition	
MSRP	UMRP			MSRP	UMRP			MSRP	UMRP		
\$1,275	\$1,020			\$1,775	\$1,420			\$1,900	\$1,520		

Specifications

Solid 316L Machined Stainless Steel Construction
 Forward rotating COMFORTFEEL™ lever handles
 Hot side lever is spring loaded for automatic shutoff
 1/4 turn ceramic disk cartridges
 Spout rotates 360°
 Laminar Ideal Flow.
 Thermally insulated spout
 Provides filtered (not included), hot water, 208°F max temperature
 Provides filtered (not included), cold water (not chilled)
 Optional base ring included
 8 5/8" fill height from deck to spout outlet
 Total height 13 1/8"
 1.8 GPM maximum flow rate
 Maximum counter thickness 2 1/4"
 Minimum install hole diameter 1 3/8"
 Compatible with reverse osmosis filtration systems
 Limited Lifetime Mechanical and Finish Warranty
 For use with full flow filtration unit
 For use with Digital Instant Hot Water Tank (required)

Construction

Solid 316L machined stainless steel construction
 Available in Polished, Matte, PVD Gun Metal Gray™, PVD Satin Black, PVD Brushed Gold, PVD Rose Gold
 Indoor & outdoor
 Limited Lifetime Warranty
 Made in Italy

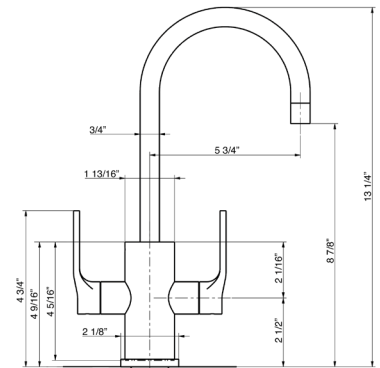

The Galley Tap

Digital Instant Hot Water Tank

Available Spring 2019

D IHWT SS



Ideal Hot Water Tank™ (Required)

MSRP	UMRP
\$595	\$476

Specifications

Digital control touch panel
 Adjustable temperature settings = 3° increments
 Seven preset temperatures = 167°-208°F
 Digital temperature control within 1-2°
 On/off button with vacation mode feature
 1500 watt/120-volt ceramic encased rapid-recovery element
 60 cups per hour capacity
 Standby reheat feature with low energy consumption 1W
 Standby reheat at 6° temperature-drop
 Built-in dry Burn and overheat sensors
 Built-in 60 psi RV with patented Baffe Fill System
 Encased element prevents limescale build-up
 Double venturi reduces faucet "dripping/spitting"
 Compatible with reverse osmosis filtration systems
 Space-saving 7.5" W x 7.5" D x 10.75" H
 Cabinet-side or floor-mount install options

Construction

304 stainless steel tank 0.6 USG (2.4 litres)
 Five Year Warranty
 UL Certified